

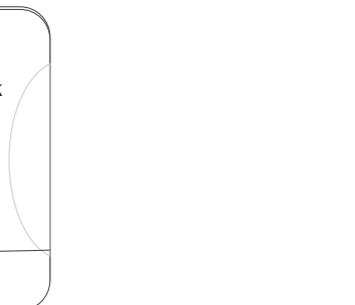

WI-CPE110-KIT

2.4GHz 300Mbps 1km Long-range Outdoor Wireless Transmitter
Quick Installation Guide

1. Package Contents



2 x Wireless Transmitter

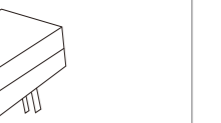

2 x 24V PoE Adapter

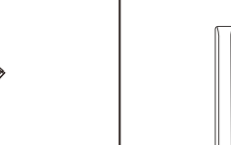

2 x 0.9m RJ45 Cable

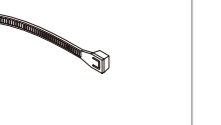

4 x Nylon Cable Tie Accessory



1 x Installation Guide

2. Hardware Introduction

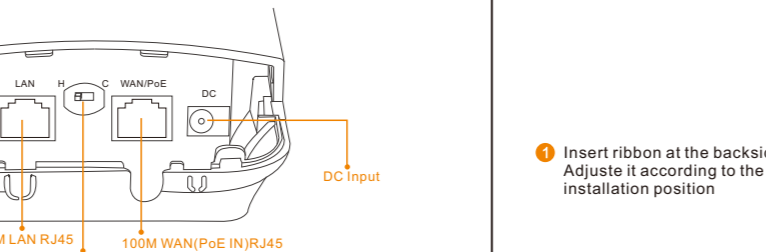

Button	Description
DIP Switch	H: Base station mode, supports wireless point-to-point and point-to-multipoint long-distance transmission. C: CPE mode, a receiving point for connecting a wireless base station.
RST Button	Short press: Search for another wireless transmitter on a different mode (Wi-C status) and pair each other. Long press over 5 seconds: Restore the factory default configuration.



LED Indicator	Status	Description
Power	Solid On	Power on.
	Quick Blinking	Searching for another device and pairing.
	Off	Power off.
WAN & LAN	Solid On	The port is linked.
	Off	The port is not linked.
Wi-Fi	Blinking	The wireless activated.
Wireless Signal	Solid On	The stronger the wireless signal, the more LED indicators are on.
	Off	The wireless signal is too weak or the wireless pair is not linked.

3. Installation

1 Insert ribbon at the backside bracket hole. Adjust it according to the pole size and installation position.

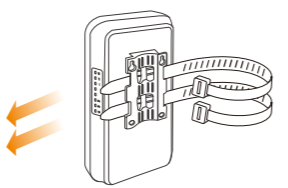

2 Install the device on the pole and tighten the ribbon.

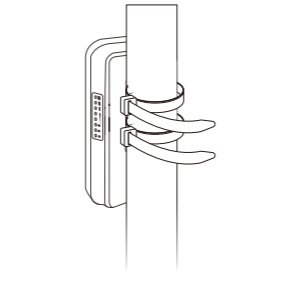

3 Hold on the buckle to take down the device back cover. Insert the net cable into the network port, then fasten the back cover.

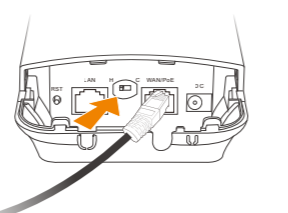

4. Application

Point to Point Connection for CCTV

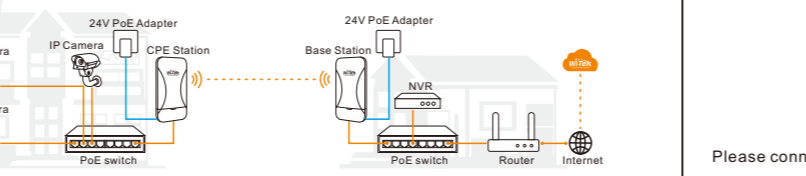

OR

Point to Multi-Point Connection for CCTV

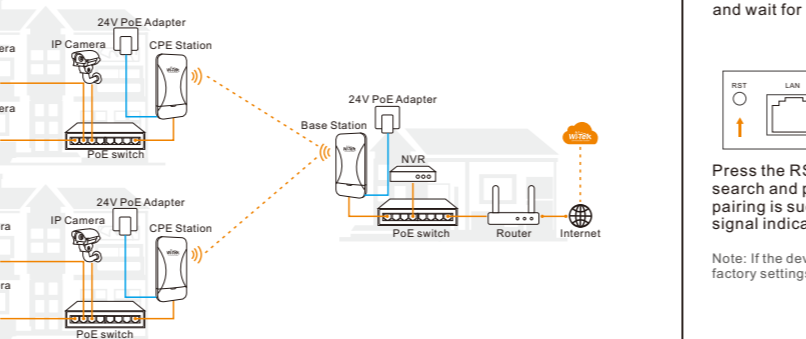

5. Management

Management by WEB

A) Set the device to **Base Station Mode**.

Step 1. Set PC network IP to 192.168.1.X (X: 2~50), subnet mask: 255.255.255.0, same network segment as device. Launch the browser and enter the login page default IP: 192.168.1.88 or 192.168.1.89, input the login password: admin, and click <login>.

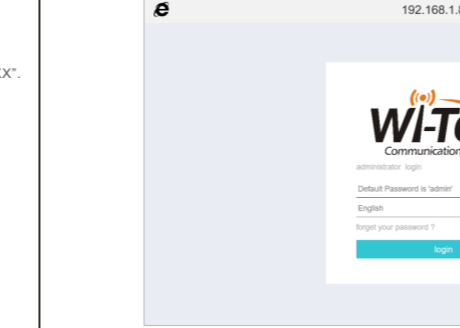

Step 2. Go to the "Wizard" page, select <Base Station Mode>, and click <Next>.

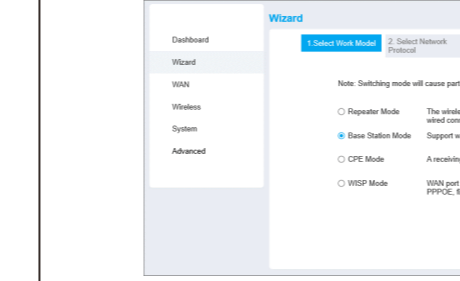

Note: If the device has been set up and need to use the quick pairing function, restore the device to factory settings first.

Quick Pairing



Quick pairing applies to PTP application. Set the DIP switch of the two devices to different modes (one to H and another to C), and wait for restart to switching mode.

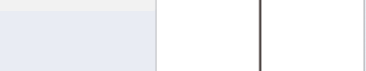

Press the RST button at the same time, power indicator starts to blink, the device starts to search and pair each other. When the Wi-Fi indicator of the two devices is on, the quick pairing is successful, and the signal strength can be judged according to the wireless signal indicator.

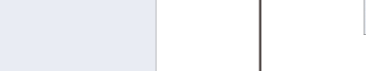

Note: If the device has been set up and need to use the quick pairing function, restore the device to factory settings first.

Step 3. Select the network protocol based on the network design. For example, select <Dynamic IP(DHCP)> and click <Next> in the "Select Network Protocol" page, and click <Next>.

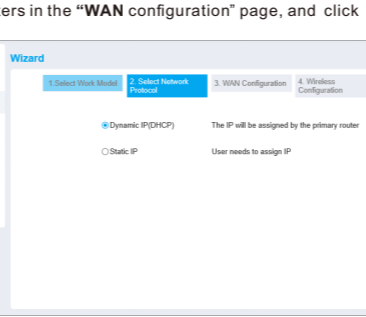

Step 4. Type in the <SSID>, <Encryption> and <Password> in "Wireless Configuration" page. Then click <Next>. Review the configurations and click <Confirm> to complete the wizard in the "confirm" page. The device will save the configuration and restart to switching mode.

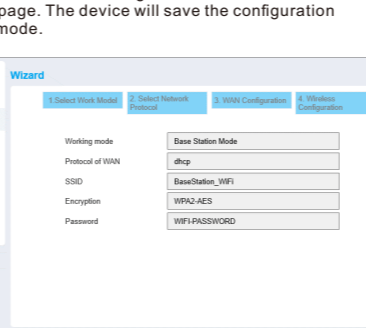

Step 5. Repeat the A) step 1, login the management WEB. Go to the "Wizard" page, select <CPE Mode>, and click <Next>.



Step 6. Repeat the A) step 3, Specify the parameter in the "WAN configuration" page and click <Next>. Click <Start Scan> to search and select the base station wireless in the "Wireless Configuration" page.



Step 7. Type in the base station wireless parameter and click <Next>.

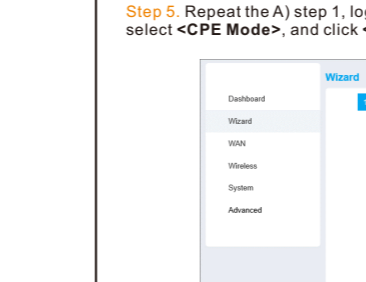

Step 8. Review the configurations and click <Confirm> to complete the wizard in the "confirm" page. The device will save the configuration and restart to switching mode.

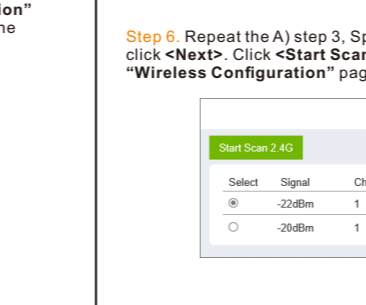

Finish the above steps and wait for the device to restart. The PTP application configuration is complete when the signal strength indicators of both devices are on.

If you want to configure the PTMP application, repeat steps B) 5 ~ 8 for the other device after completing the PTP application.

Warranty Card

Username	
Address	
Telephone No.	
Purchase Shop	
Purchase Address	
Product Model No.	
Purchase Time	
Serial No.	
Dealer Signature	

- If the product defects within three months after purchase, we will provide you a new product of the same model.
- If the product defects within the three-year warranty period, we will provide the professional maintenance service.
- Proof of purchase and a complete product serial number are required to receive any services guaranteed as part of the limited warranty.
- Any other defects that are not caused by workmanship or product quality, such as natural disasters, water damage, extreme thermal or environmental conditions, sticker damaged, warranty card losing will disqualify the product from limited warranty.



Technical Support Company Website Cloud Management

Wireless-Tek Technology Limited
Address: Biaofan Technology Building 402, Bao'an street, Baoan District, Shenzhen City, Guangdong, China
Website: www.wireless-tek.com
Tel: 86-0755-32811290
Email: sales@wireless-tek.com
Technical Support: tech@wireless-tek.com

